

MOTOR SPECS/PERFORMANCE DATA 115V/230V	
MODEL NUMBER	YONS694X
HP	1.5
RATED SPEED	1725 RPM
VOLTAGE	115/230
PHASE	1
FLA	60
FRAME	16.8/8.4 AMPS
ENCLOSURE	56C
IP RATING	TEFC
INS CLASS	F
EFFICIENCY	77%
POWER FACTOR	77%
FULL LOAD TORQUE	4.44 Ft. Lbs (6.02 Nm)
START TORQUE	12.5 Ft. Lbs (17 Nm)
SERVICE FACTOR	100/50 Amps
MAX AMP	1.0
CAPACITOR SIZE	600 uF/25V
DUTY	CONTINUOUS
POLE	4

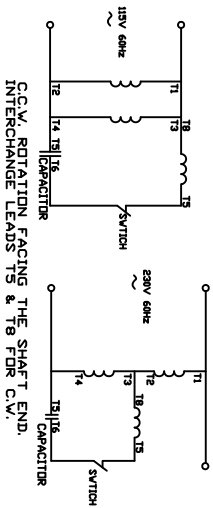
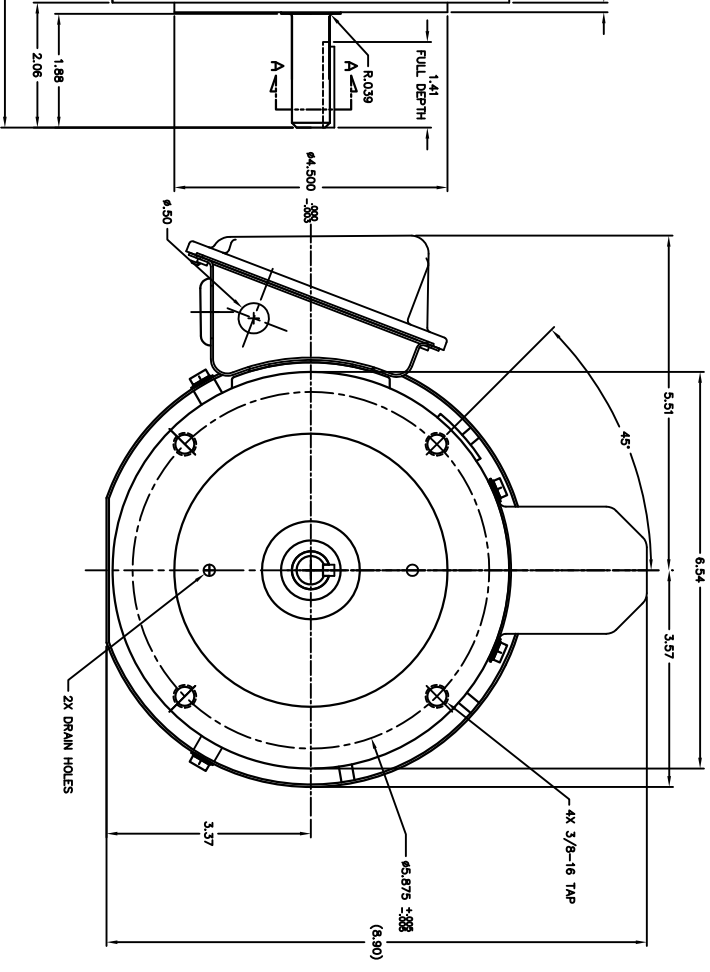
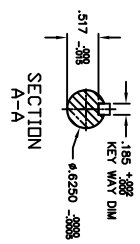
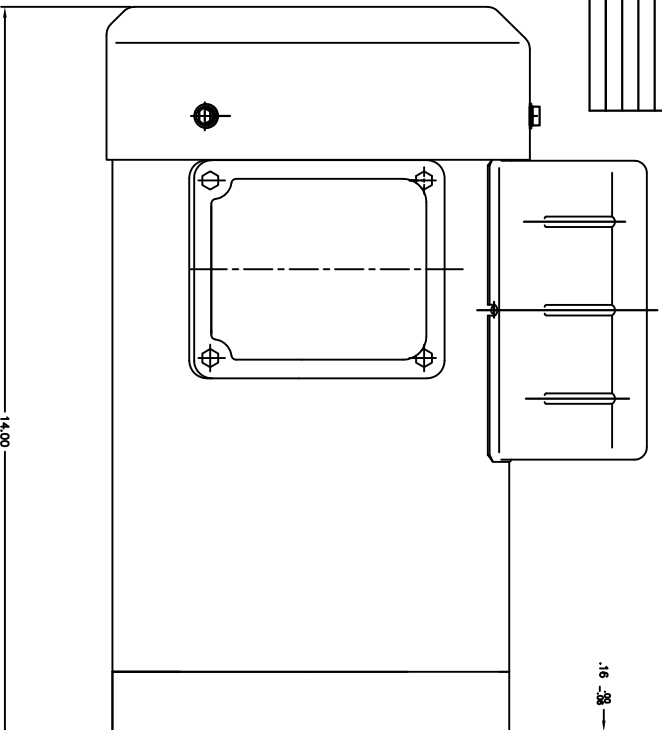

- NOTES:
1. INTERPRET DIMENSIONS AND TOLERANCES PER ANSI Y14.5M.
 2. INTERPRET DIMENSIONS AND TOLERANCES PER ANSI Y14.5M.
 3. INTERPRET DIMENSIONS AND TOLERANCES PER ANSI Y14.3.

REV	ISS. NO.	REVISION	DATE
A	XX	RELEASE FOR WEBSITE	11/29/20

NOTES: CONSULT APPROVALS

APPROVALS

DESIGNED BY	DATE	APPROVED BY	DATE
DR. S. S. 1. PH.			

MOTOR: 1.5 HP, SS, 1 PH.

56C, YONS694X

APPROVED BY: 003324

DATE: 11/29/20

SCALE: 1/1

SHEET 1 OF 1